



East Hampton Studio

THE HAMPTONS LARGEST VENUE



www.easthamptonstudio.com | info@easthamptonstudio.com

Who We Are

East Hampton Studio is a 31,000 sq ft. facility that stands in a class of it's own. Located in the Hamptons, it is the largest indoor facility in Suffolk County and can accommodate up to 3,200 people, and seat up to 1,200 for dinner. East Hampton Studio is a multi-use facility that accommodates anything from private events, Concerts, benefits, corporate meetings to motion pictures productions, TV productions, photo shoots and more.

Supported by a partnership of preferred industry leading vendors such as Empire entertainment, BML-Blackbird, Ocean Productions and more. East Hampton Studio offers turnkey solutions for every type of event or production need. Our highly adaptive spaces consist of an 18,400 sq. ft. main soundstage, a 3,500 sq. ft. studio, and the ability to erect large out-door tents. East Hampton Studio has the ability to offer multiple unique environments for your event or production.

East Hampton Studio shares ownership with The Enclave Inn Hotel Group, the largest chain in the Hamptons with three properties located throughout the Hamptons.

Past clients include Mercedes-Benz, AT&T, SCOPE Art Show, Cirque Hamptons, Steven Bauer's Show "Playtime" and his band Underground Junction, Fran Drescher's Cancer Schmancer 2011, Hamptons Rocks for Charity featuring Crosby, Stills and Nash, and motion pictures production like "Something's Gotta Give" (Diane Keaton and Jack Nicholson), "Paper Man" (Jeff Bridges), and "The Romantics" (Katie Holmes, Anna Paquin, Josh Duhamel)



The Facts

- 31,000 sq ft studio and office space
 - 18,400 main soundstage with 46 ft ceilings (160' x 110')
- Accommodates 3200 standing, 2500 concert, and 1200 seated dinner
 - 3,500 sq ft studio with office
- 16' x 16' overhead doors, accommodating drive-in / load-in of semi-trucks
- Prime location in the heart of the Hamptons with no noise restrictions
 - New York State approved film, TV, and commercial location with 30% tax credit incentives available
 - 32' x 20' Cyclorama
 - 36' x 24' stage with a DB tech Line Array concert and audio system
 - 40' x 30' Green screen available and 2 additional studios
- Situated on 3+ acres of land with space available for additional outdoor tenting
 - State of the art air conditioning, heat, and soundproofing
- Shared ownership with The Enclave Inn Hotel Group, the Hampton's largest hotel chain
- Production office, dressing rooms, and ancillary support spaces available
- Live telecast available to 5 million homes from Montauk to Manhattan
 - Ample parking to support events up to 3,200
 - Close proximity to East Hampton Airport



Preferred Vendor Partners



Event design, logistics, talent acquisition, project management
www.empireentertainment.com



Lighting, rigging, and video services
www.bmlblackbird.com



Production management and concert and audio equipment services
www.oceansandl.com



Resident, lifestyle broadcast series providing coverage of all East Hampton Studio events



Preferred catering services
www.carlyleonthegreen.net



Event and décor rentals and furnishings
www.classicpartyrentals.com



Outdoor tenting, flooring, and compliance equipment
www.ptg.biz



In-house PR services
www.lawlormediagroup.com



Photography, editorial, and production services and equipment
www.splashlight.com



Venue affiliated broadcast facilities and platform
www.vvh.com



Past Events



Galas



Photo: Fran Drescher's Cancer Schmancer Benefit



Concerts & Entertainment



Photo: Crosby, Stills & Nash

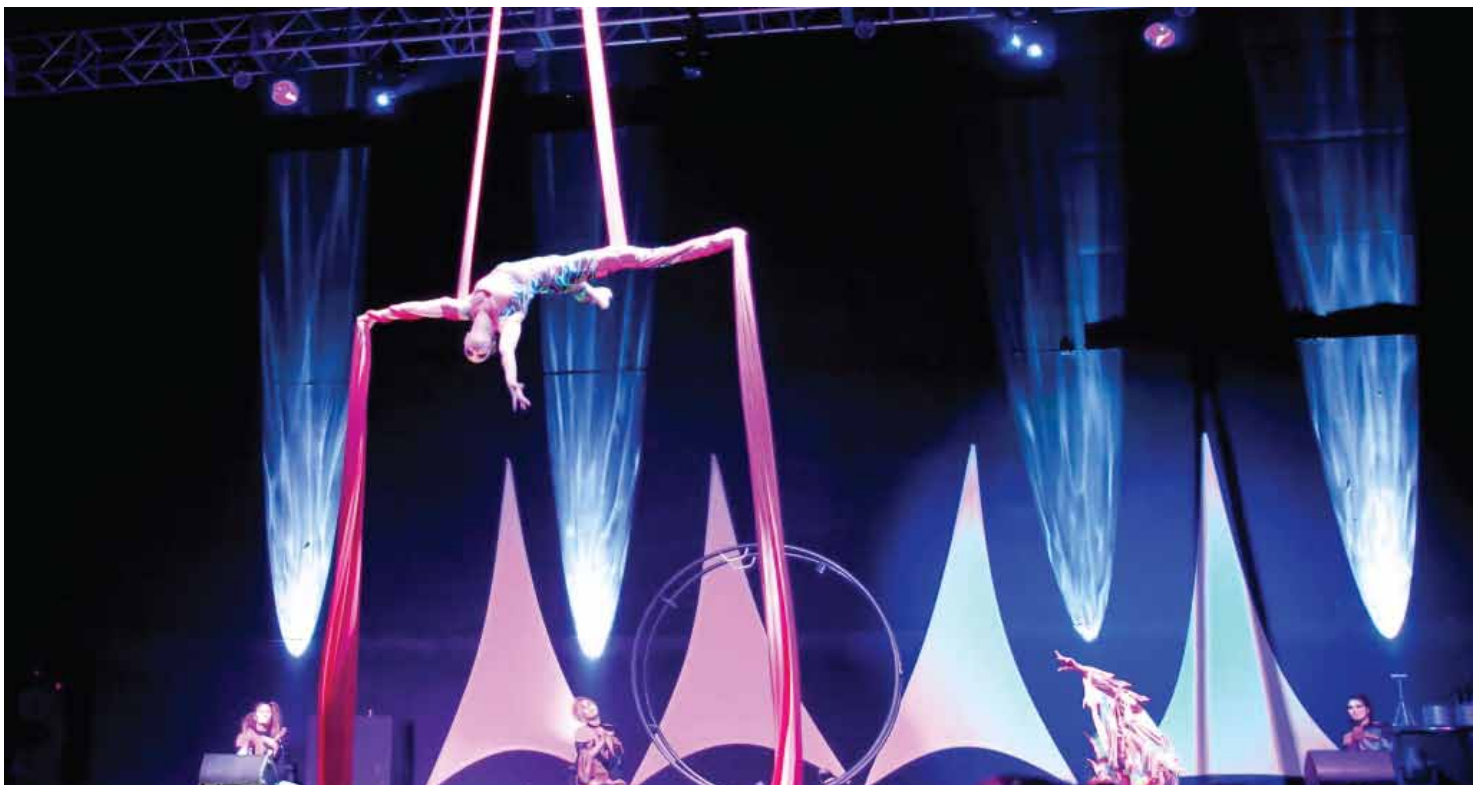

Photo: Cirque Productions

Film & Television Productions



Photo: Jeff Bridges in "Paper Man"



Photo: Anna Paquin & Katie Holmes in "The Romantics"



Photo: Jack Nicholson & Diane Keaton in "Something's Gotta Give"

Floor Plans

Main Sound Stage

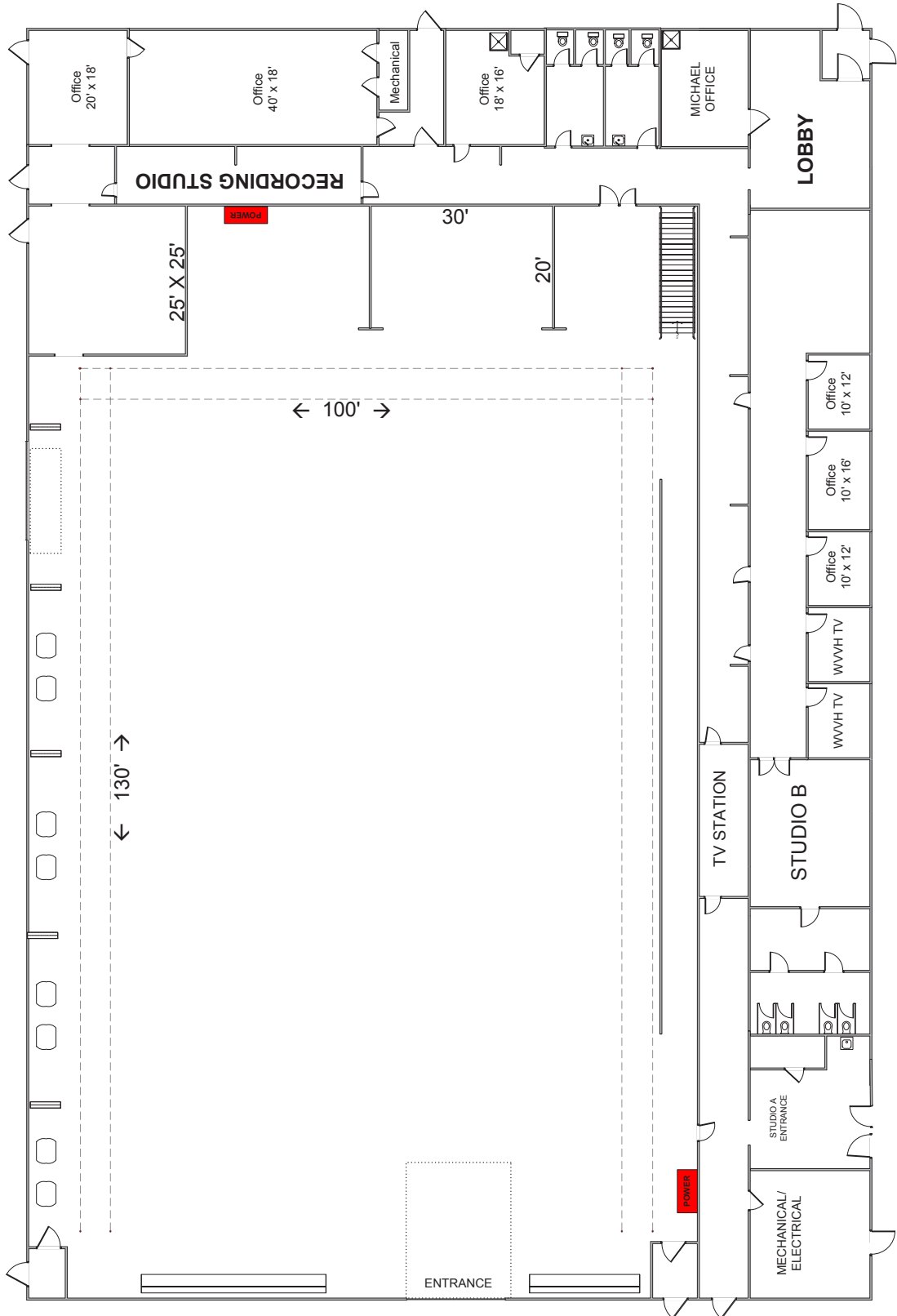

Floor Plans

Seating Layout

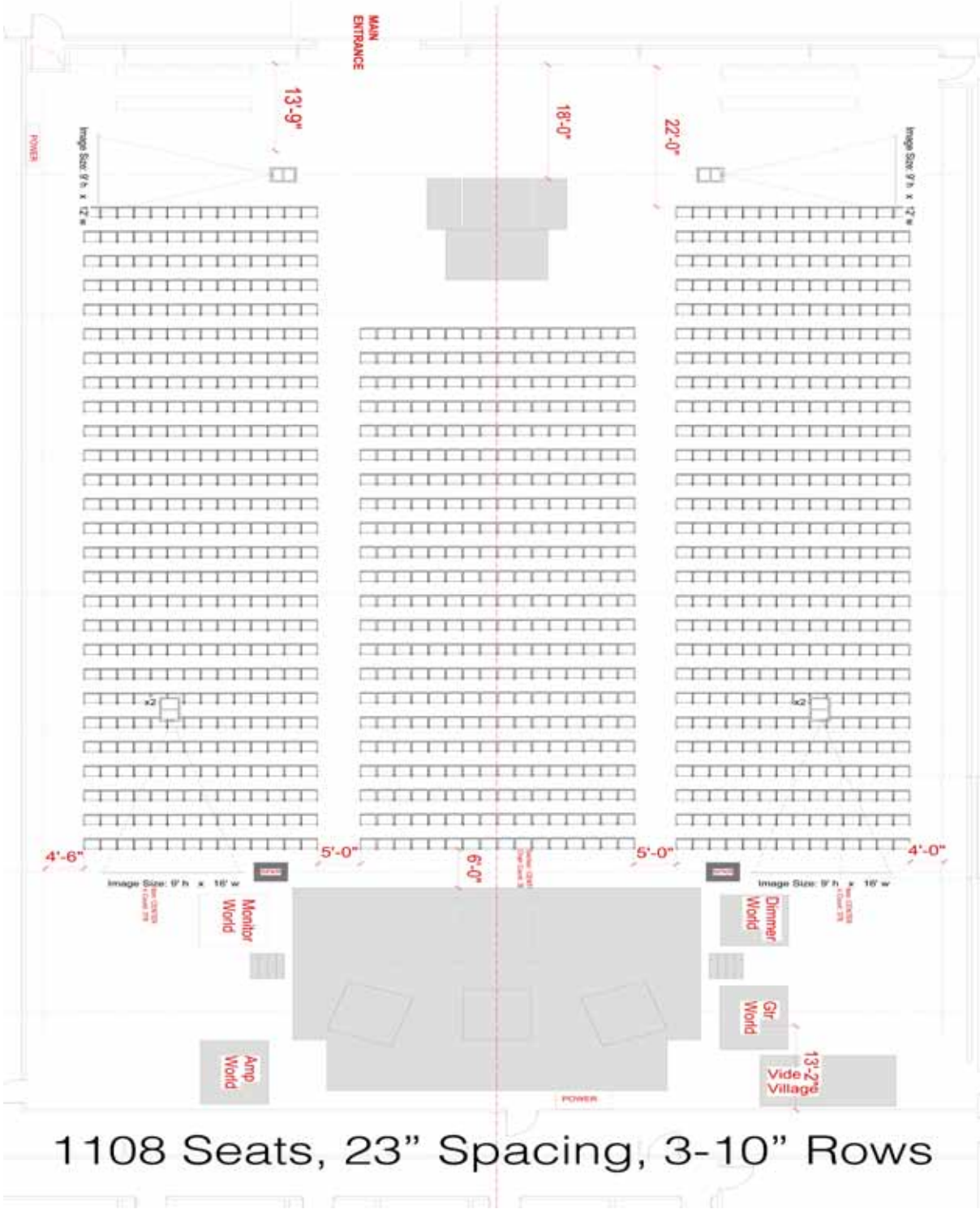

Lighting Plot

Technical Layout

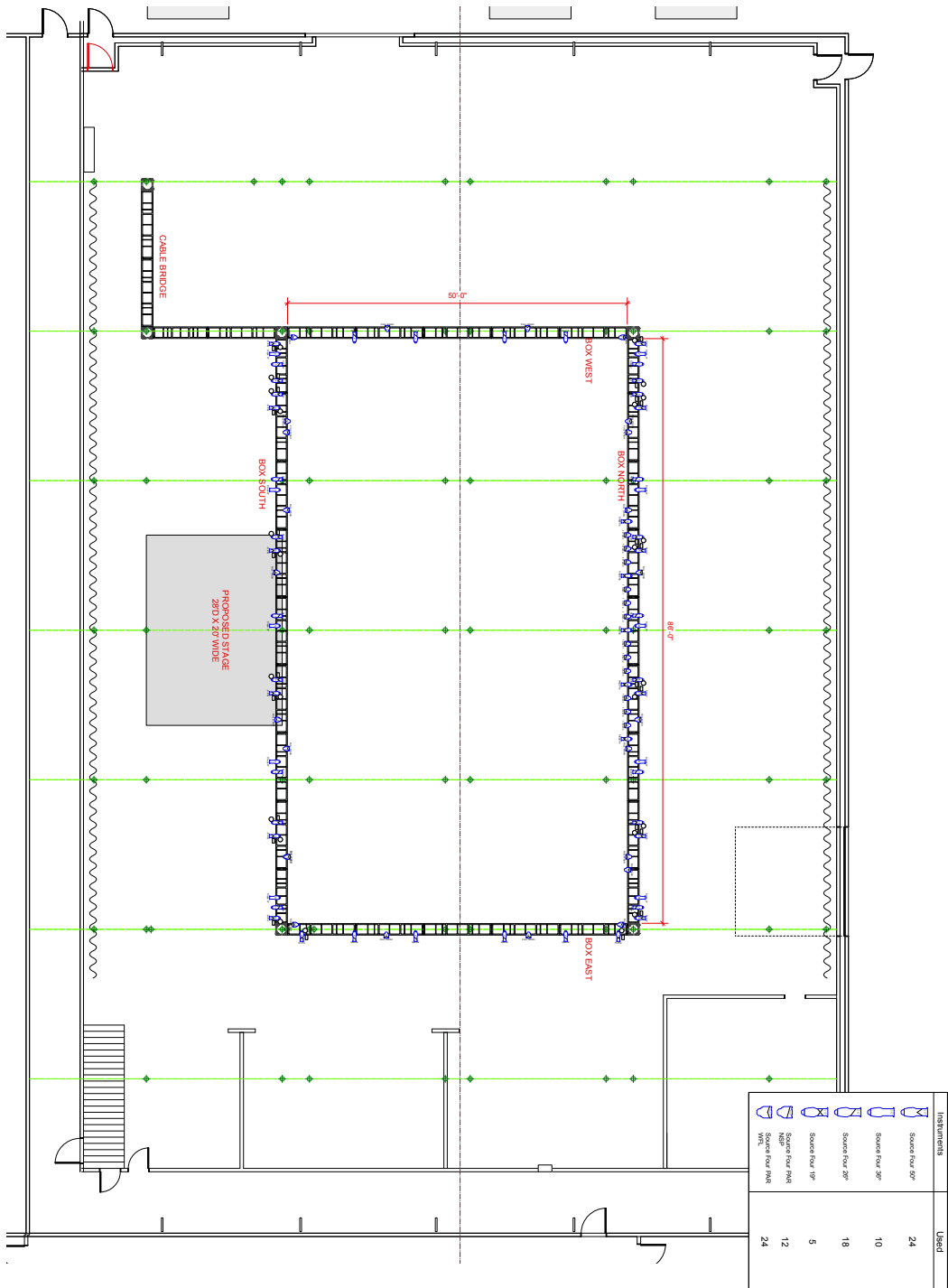

Technical Specifications

AUDIO

- DB Technologies Line Array
- (4) DVA T12 Long-Throw cabinets
- (12) DVA T4 Nearfield-Midfield cabinets
- (4) DVA S20 Subwoofers (2x18. 2000 watts each)
- (6) 12" DB stage/floor monitors
- (1) 15" Drum fill/monitor
- (10) 12" 2way PA speakers mounted through out the venue
- (2) Wireless handheld microphones
- (2) Wired microphones
- (16) channel mixer
- (6) Mackie 12" powered speakers
- (2) QSC K SUBS
- (2) JBL 2x18 subs
- (2) JBL 1x15 2 way PA speakers
- (4) Crown macrotech power amps
- (2) Yamaha LS9 - 32 channel digital mixers
- (2) Presonus 24 live digital mixers
- (6) Shure SM 58
- (4) Shure BETA 58
- (8) Shure SM57
- AKG D112
- (2) SM 81

STAGING

- 36' W x 24'D x 2'H
- Carpet top riser staging with additional equipment available as needed

LIGHTING

- Pre-installed lighting grid with approximately 300 feet of flown truss on motors including over 100 conventional fixtures, cabling, dimming, and control system

INTERNET

- Optimum Ultra (101 MPS Download, 15 MPS Upload) Wi-fi and ethernet connection

Parking

- 150 on location parking spaces
- 250 additional parking spaces available for an additional fee
- Additional parking lots available for rent nearby

OTHER

- (4) DI boxes
- (24) Channel live recording to Pro Tools available
- On-site storage
- 3,500 sq. ft. additional studio space
- On-site dressing rooms, production office facilities available

Rental Package

All rentals include:

- House Event Supervisor (12 hrs. per day)
- Standard lighting package
- House power
- House sound package
- House staging package
- Use of parking lot (up to 150 vehicles)
- Use of existing dumpster
- Basic building security
- Use of all house rooms and facilities
- Use of house table & chair rental inventory
- Basic cleaning & porter services



Contact Us

www.easthamptonstudio.com

info@easthamptonstudio.com

631.965.0050

